

Bidwell Training Center

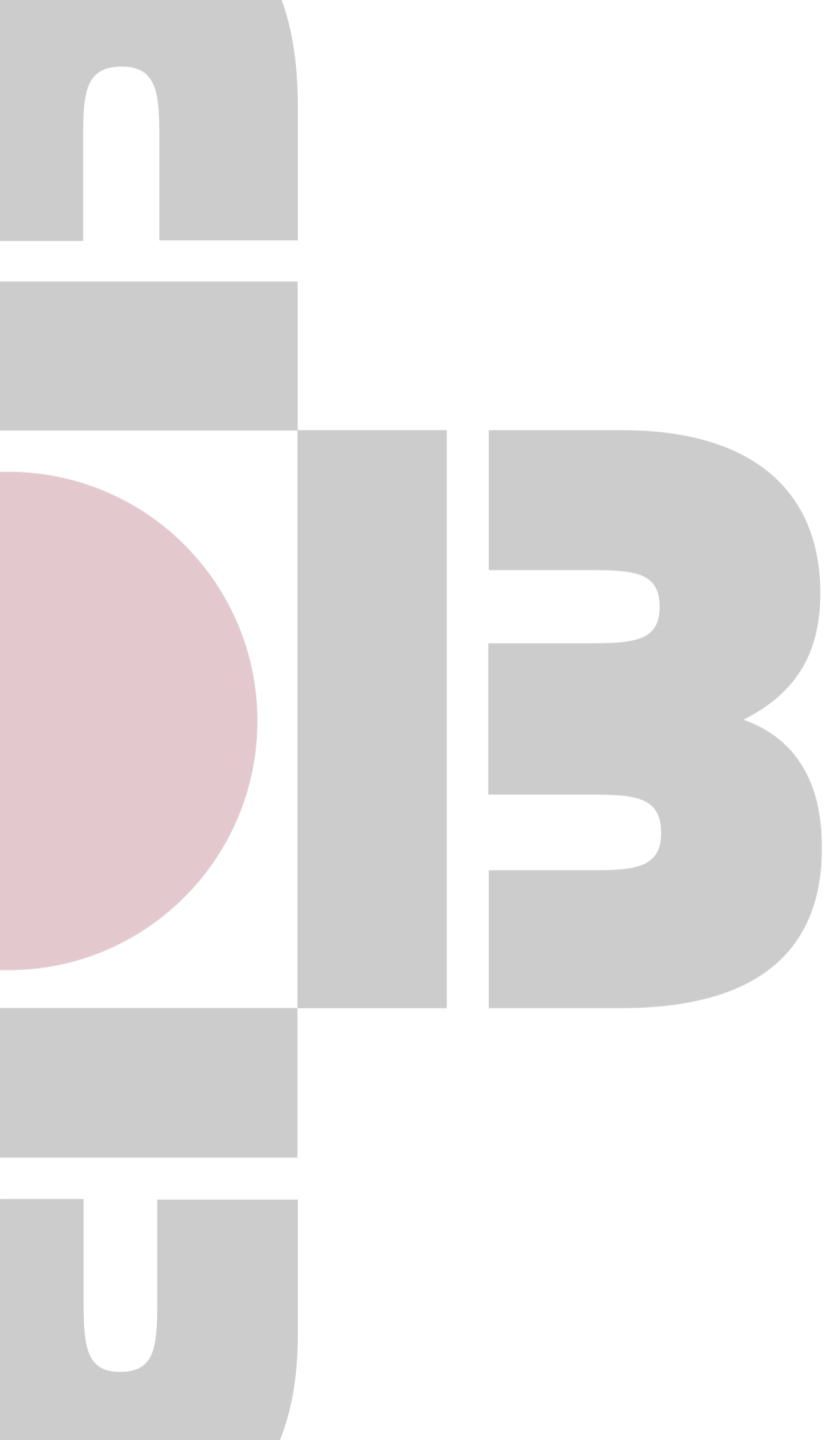

Bidwell Training Center

Virtual Tour

Harbor Gardens

- Located at 1650 Metropolitan Street, UPMC Harbor Gardens houses our Student Services and Admissions offices, as well as our Medical and Horticulture Academic Departments



Admissions and Student Services

Assessment testing is held in the conference room in the Student Services office, located on the first floor of Harbor Gardens. Admissions, the Registrar, Advising and Placement, as well as Student Counseling Services are all located here, too.

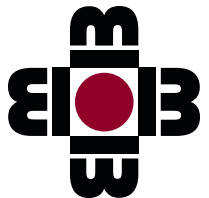

Bidwell Training Center

Medical Suite



Located on the second floor of Harbor Gardens, and accessible by stairs and elevator, our Medical Suite contains faculty offices,

The Pharmacy Technician Lab, Medical Coding and Billing, and Medical Assistant Classrooms,





and lockers for students to store their educational and personal supplies.

Drew Mathieson Center



Directly next door to Harbor Gardens sits The Drew Mathieson Center, which contains a Horticulture classroom,

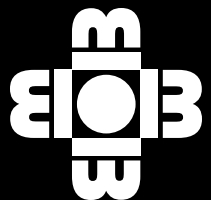

Bidwell Training Center





as well as a learning and retail greenhouse that grows seasonal plants, such as hydroponic tomatoes and herbs, orchids, poinsettias,

hibiscus, and hydrangeas.

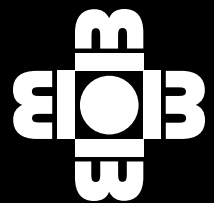

Bidwell Training Center



PARKING FOR STUDENTS

Free, on-street parking is available on Metropolitan Street and surrounding streets.

1850 Metropolitan Street

Our main building, located one and half blocks down from Harbor Gardens, houses our Culinary and Chemical Laboratory Technician programs, as well as our Medical Assistant Lab. We share the building with other programs under the Manchester Bidwell Corporation umbrella, including Manchester Craftsman's Guild Youth and Arts and MCG Jazz.

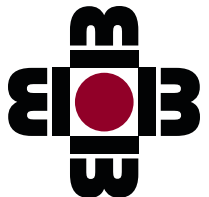

Bidwell Training Center

Lobby and Main Reception

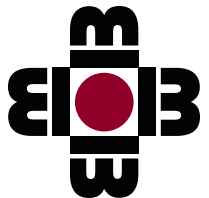
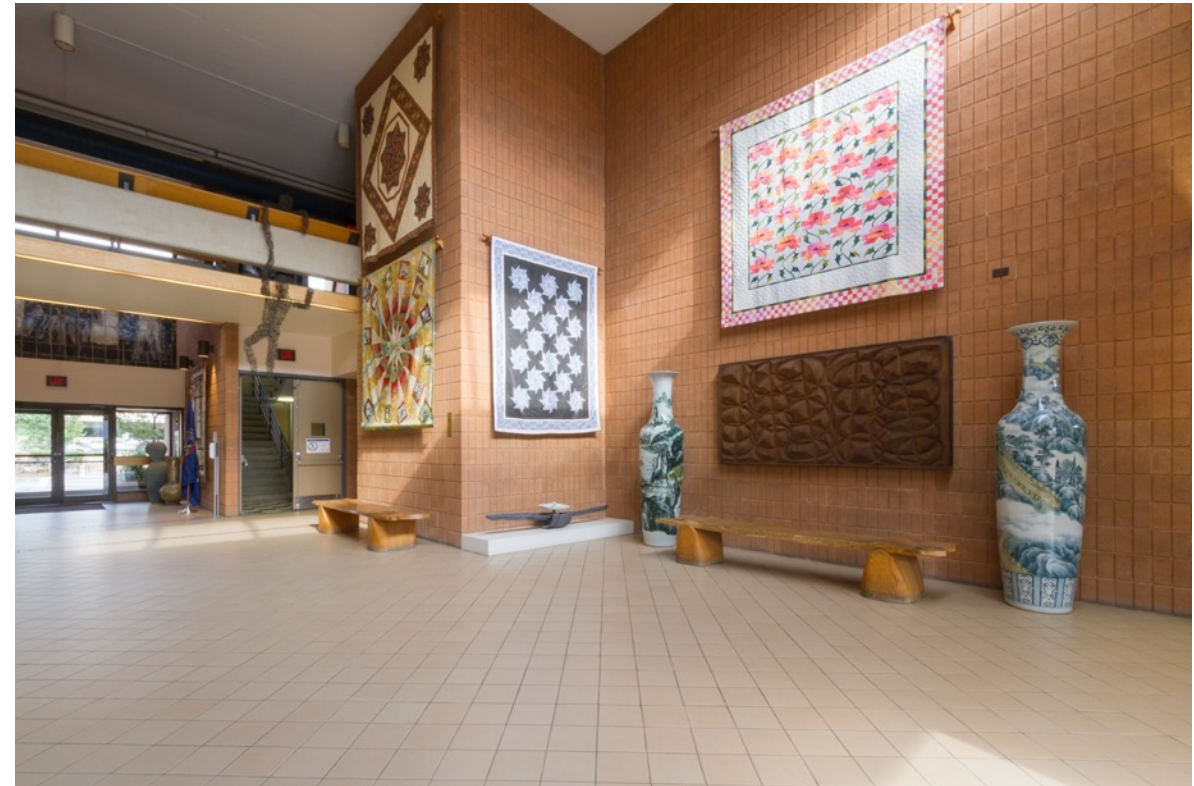

Bidwell Training Center

Library

The library is open before, during, and after classroom hours for students to utilize resources, complete research, and work on assignments.

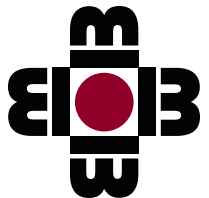

Bidwell Training Center



The second floor of 1815 Metropolitan houses classrooms and



the Medical Assistant Lab with simulated patients, prosthetic arms used for teaching blood draw technique, and other instruments essential to patient care.



Back on the ground floor, the Dining Hall opens off the main lobby.



and leads into the kitchen areas of our Culinary Arts program.





Behind the kitchen is located the Culinary Arts Ampitheatre classroom.



The last stop on our tour, The Chemical Lab, is located just down the hallway from Culinary Arts.



In addition to state-of-the-art lab equipment for performing experiments and R&D, the lab also provides additional classroom space at the front of the room.

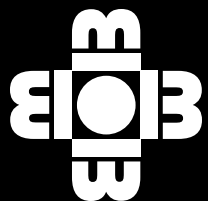

Bidwell Training Center

Thank you for taking our Virtual Tour!

We hope to welcome you to Bidwell soon.

For more information on the Admissions Process, please contact us at **412-402-9761**

